

## WHAT'S IN THE BOX

**Note:** The port layout on your modem may be slightly different.

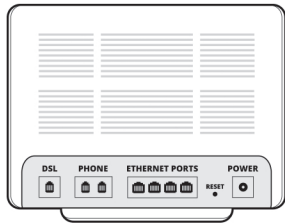

DSL Modem

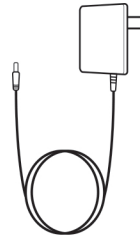

Modem Power Adapter



Ethernet Cable

## HOW TO CONNECT YOUR DSL MODEM

After a DSL connection has been installed in your home by a technician, follow these instructions to connect your DSL modem:

- 1** Connect the **DSL Modem** to the active phone jack on the wall using the **Phone Cable** provided.
- 2** Connect the **DSL Modem** to a power outlet using the **Power Adapter** provided. If the device does not power on, look for a power switch.
- 3** Your DSL Modem will automatically download the proper configuration files. Please wait a few minutes for this step to complete.
- 4** Connect your DSL modem to your wireless devices using the default Wi-Fi network name (SSID) and password (WiFi Key) which are located on the manufacturer sticker that is on the bottom of the modem.

If you have trouble connecting to the modem wirelessly, connect a computer with an ethernet port, using the ethernet cable provided. You will not require a password for a wired connection.

Visit [support.fongo.com](http://support.fongo.com) for instructions on changing the name and password of your WiFi network.

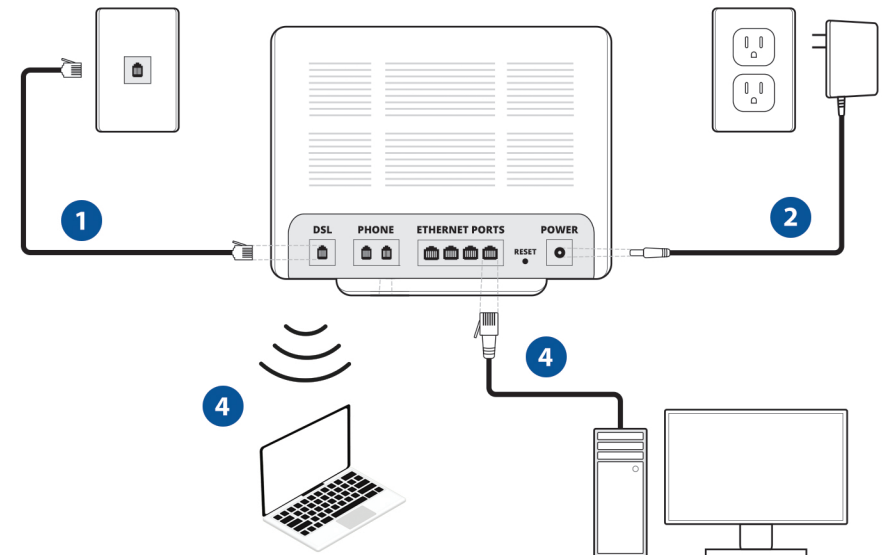

**Note:** Make sure the modem has been connected in the correct order. If you are still having trouble: Unplug the modem and wait 10 seconds. Reconnect the modem again starting at **Step 1**.